

Twilight Spectre Series.

@newgiza

There is an hour when dreaming
begins and life turns from
mundane to magical.

There is a place that sings a
natural lullaby to the hues of the
daylight so they rest with starlit
dreams, larger than life.

— Twilight Spectre Series.
@newgiza

01.

Twilight Spectre Series

Uninterrupted Views, In the Most Privileged Location.

Disclaimer: 1. Drawings are not to scale. 2. The architectural details are based on Concept Design information only, and final As-Built conditions may vary. 3. All images used are for illustrative purposes only and do not represent the actual size, features, specifications, or fittings. 4. Artlife Developments reserves the right to make revisions/alterations, at its absolute discretion, and without liability.

Twilight Spectre Series.
@newgiza



Introducing a contemporary interpretation
inspired by ancient supremacy, to blur the
lines between the past and present.

Carrying forward an ancient **legacy** that captures a distinctive sense of **evolution.**

Twilight Residences offers serviced apartments strategically located in Newgiza, providing seamless connectivity to essential amenities and breathtaking views. This exclusive development features only six buildings, each presenting a variety of unique typologies, creating a special edition of upscale living.

Twilight Residences is designed to provide every amenity for a luxurious lifestyle, allowing residents to enjoy stunning views from every angle. Nestled within a gated private community, residents have the advantage of living close to all essential amenities while enjoying a sense of privacy and security.

Created by internationally renowned architects and designers, Twilight's master plans and landscapes reflect global design standards, ensuring both indoor and outdoor experiences that enhance the living environment.

Twilight Spectre Series

A visually striking address capturing, the
magical essence of moments between

dusk / dawn.



A Futuristic Masterpiece, Where Everything Belongs.

Twilight Residences is more than just a signature lifestyle in Newgiza. It is a timeless promise of an elevated living experience where futuristic design seamlessly intertwines with inspirational nature aesthetics.

Twilight Spectre Series.
@newgiza

02.

Accessibility and Master Plan.

A Prestigious Address, With Stunning Views.

Master planned on varied elevations to harmonize the human life with idyllic surroundings, Twilight Residences not only maximizes stunning views on the Great Pyramids of Giza, but also ensures an uninterrupted connection with verdant landscapes from every angle.

A Strategically Accessible Location.

Twilight Residences boasts a prime location within Newgiza, perfectly positioned at its highest point to offer breathtaking views. It is easily accessible through multiple routes, connecting you to essential amenities and main roads.

Located near international schools, Ace Club, and the golf course, Twilight Residences ensures easy connectivity to key areas.

This makes it an ideal choice for those seeking unmatched convenience and a vibrant community atmosphere, all within a strategically accessible setting.



Twilight Spectre Series.
@newgiza

Artlife.

Artlife Town.



NGU



Golf Course



Newgiza
Sports Club



Schools



Ace Sports
Club

Twilight Spectre.



School



NGU
Hospital

Palm Hills October



KEY	
1. VIEWPOINTS	7. PROMENADE
2. PLAYGROUND AREA	8. POOL AND DECK
3. EXERCISE AREA	9. GRASS SUNBATHING
4. TEENAGERS/ADULTS MEETING AREA	10. PATHS
5. ENTRANCE WATER FEATURE	11. VEHICULAR ACCESS
6. PROMENADE	12. WATER JETS FEATURE
	13. AMPHITHEATRE



Spectre Series 01

Spectre Series 02

Spectre Series 03

Amenities.

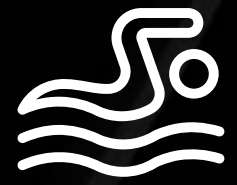

Outdoor
Heated Pools.



Gym.

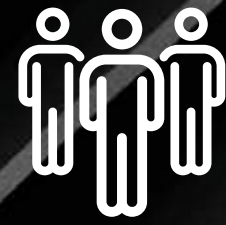

Clubhouse.



Concierge service.



Play Area.



Hotel.



Housekeeping.



Laundry.



Catering.



Underground Parking.

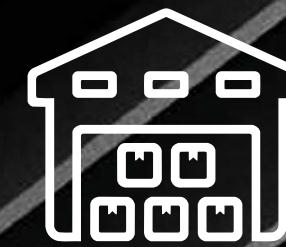

Storage Rooms.



Drivers Room.

03.

Architectural Language.

An original design
synergy that breaks free
from **static monotony.**

Twilight Residences utilizes a progressive architectural language that not only maintains a sense of energetic movement through the use of dynamic shapes, contemporary curves and elegant lines, but also ever-evolves with residents' sense of discovery for a visually engaging lifestyle.



Verdant Flourishing Landscape.



Tranquil Greenery.

Disclaimer: 1. Drawings are not to scale. 2. The architectural details are based on Concept Design information only, and final As-Built conditions may vary. 3. All images used are for illustrative purposes only and do not represent the actual size, features, specifications, or fittings. 4. Artlife Developments reserves the right to make revisions/alterations, at its absolute discretion, and without liability.

An aerial, top-down view of a landscaped park. The park features a central, winding, light-colored paved path that curves through the space. On either side of the path are lush green lawns. The landscape is densely populated with various types of palm trees, some with fronds that appear to have a yellowish tint. There are also clusters of smaller, spiky plants and some flowering shrubs with red blossoms. In the upper right corner, there is a paved area with a stone-like pattern. In the lower right corner, there is a paved area with a blue and white mosaic pattern. Several small human figures are scattered throughout the park, some walking on the path and others sitting on the grass, providing a sense of scale. The overall scene is bright and sunny, with shadows cast by the trees and people.

Lush, Sculpted Landscaping.

Disclaimer: 1. Drawings are not to scale. 2. The architectural details are based on Concept Design information only, and final As-Built conditions may vary. 3. All images used are for illustrative purposes only and do not represent the actual size, features, specifications, or fittings. 4. Artlife Developments reserves the right to make revisions/alterations, at its absolute discretion, and without liability.

Concept Design.

The concept design expresses a natural, sinuous language through flowing forms and layered greenery, creating softness and movement. Clean modern lines introduce a refined contrast, balancing organic fluidity with structured clarity to define a distinctive and timeless identity.

Concept Design.



Natural



Sinuous



Modern



Contrast



Paving.

Asymmetric path materials include recycled stone in plaza and seating areas.

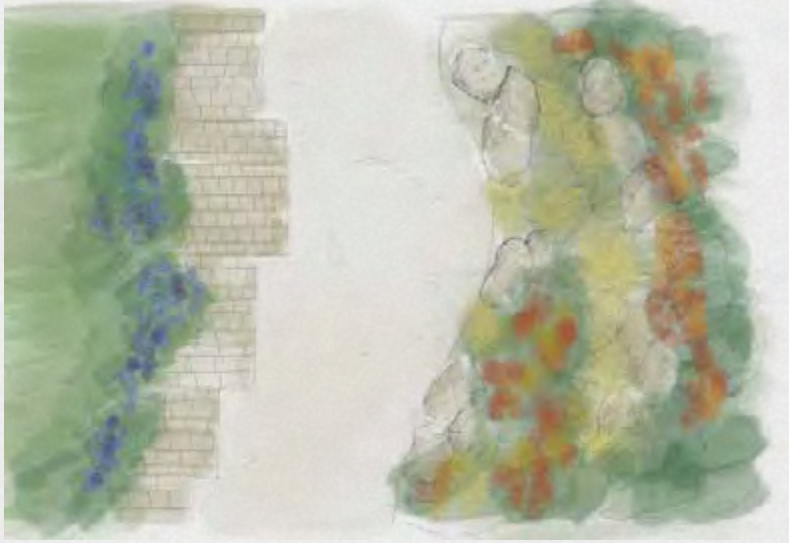
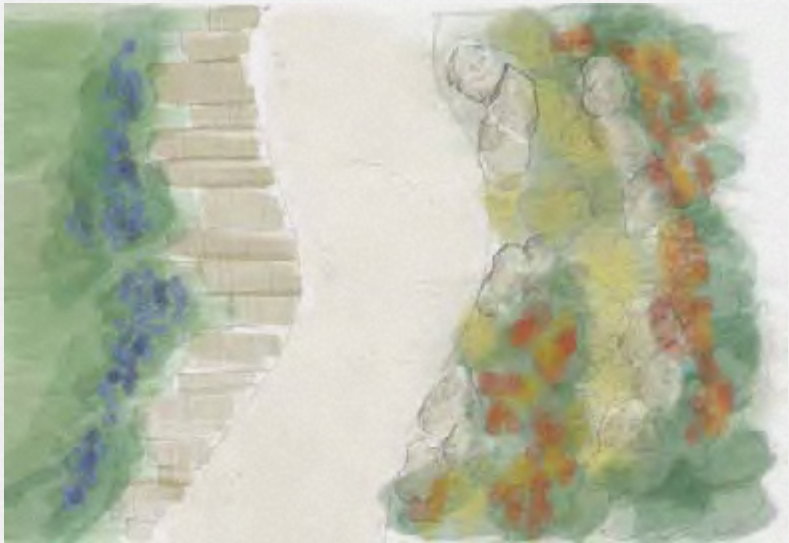
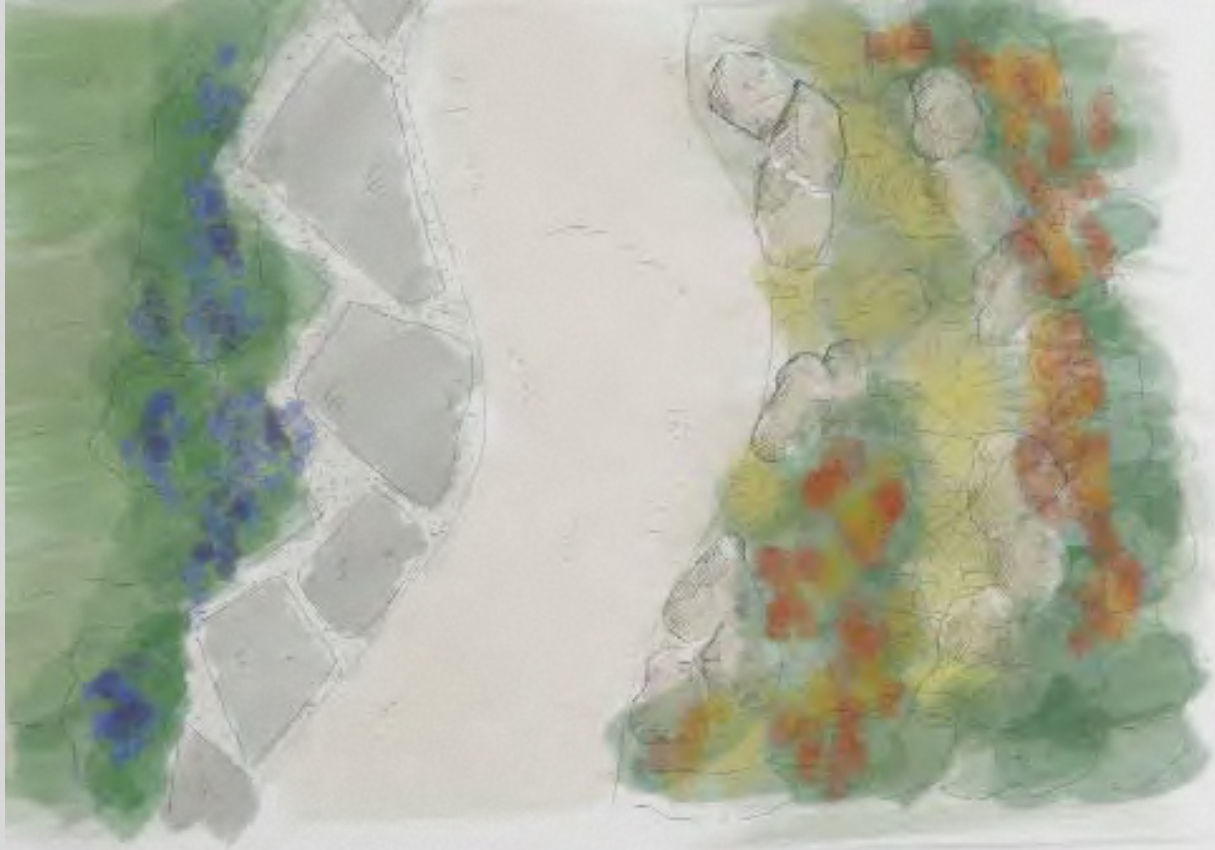
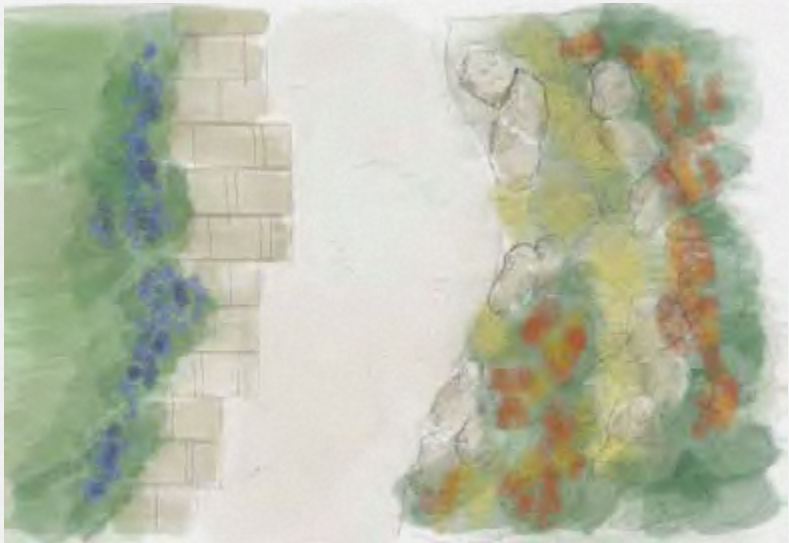
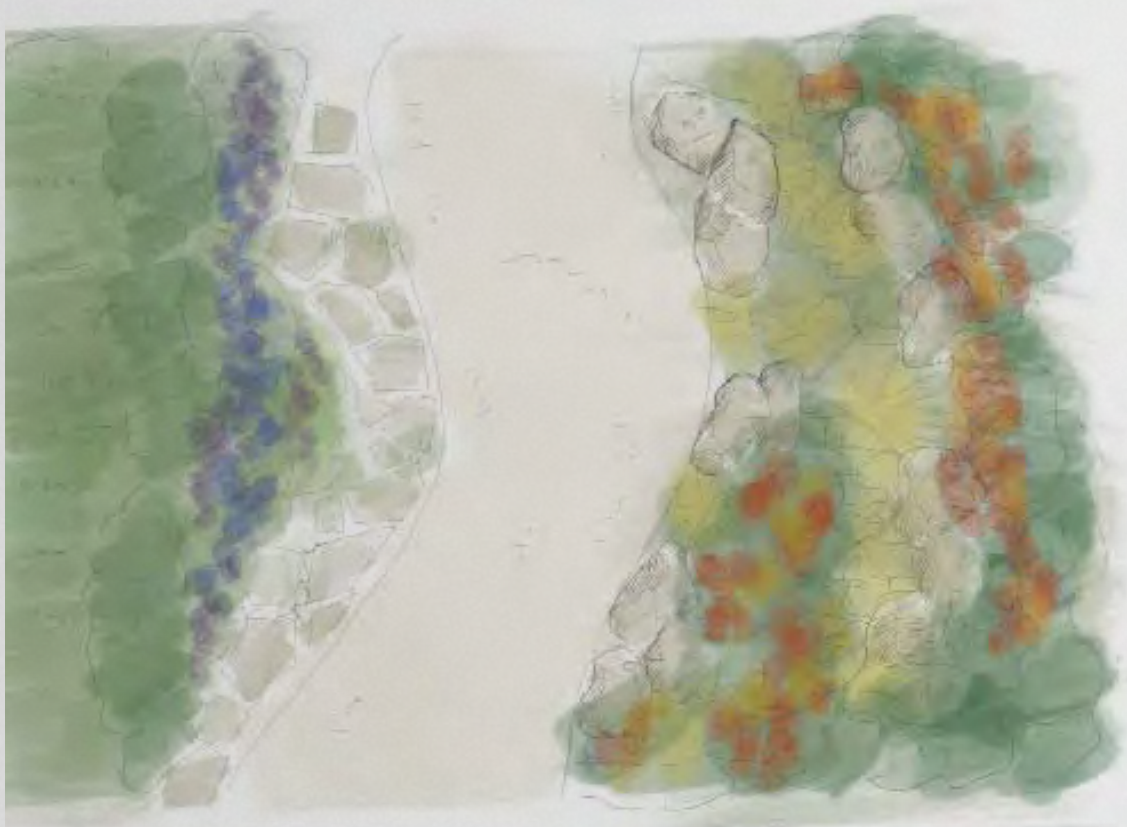



Perimeter fencing with a curved guideline

Service Road

Welcome Water Feature

Entrance terraces with large swathes of planting

Private Gardens

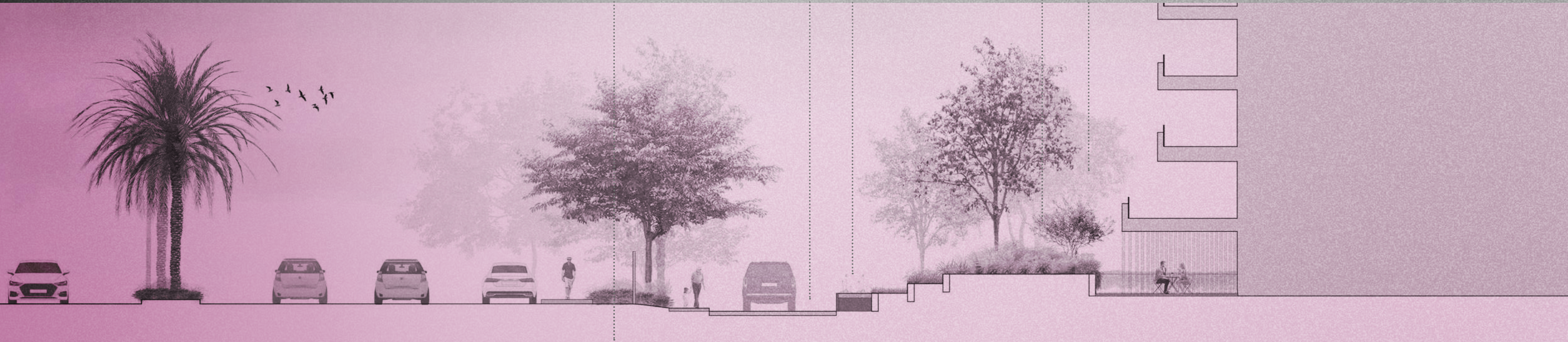

Disclaimer: 1. Drawings are not to scale. 2. The architectural details are based on Concept Design information only, and final As-Built conditions may vary. 3. All images used are for illustrative purposes only and do not represent the actual size, features, specifications, or fittings. 4. Artlife Developments reserves the right to make revisions/alterations, at its absolute discretion, and without liability.

• Low Maintenance Planting

• Intersection of roads creating naturalised squares

• Rocks recovered as slope retention

• Swimming pool lawn

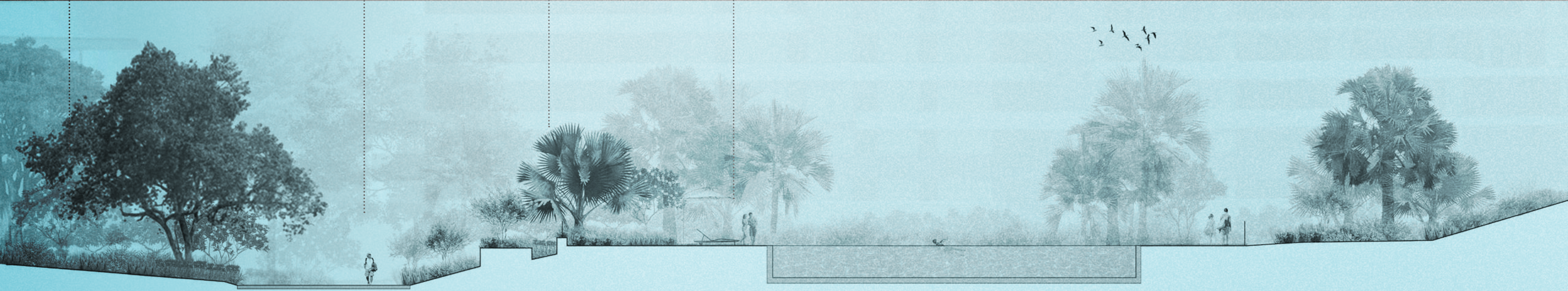

Disclaimer: 1. Drawings are not to scale. 2. The architectural details are based on Concept Design information only, and final As-Built conditions may vary. 3. All images used are for illustrative purposes only and do not represent the actual size, features, specifications, or fittings. 4. Artlife Developments reserves the right to make revisions/alterations, at its absolute discretion, and without liability.

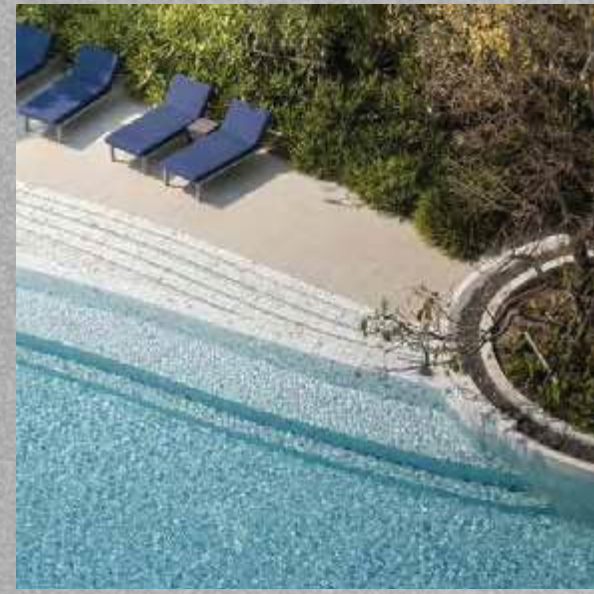
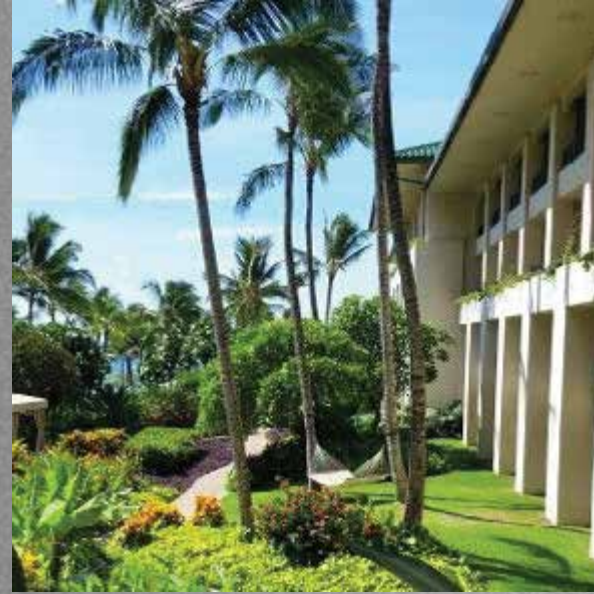

- Natural slope with rocks and native rocks

- Green amphitheatre

- Viewpoint promenade

- Water jets feature



Disclaimer: 1. Drawings are not to scale. 2. The architectural details are based on Concept Design information only, and final As-Built conditions may vary. 3. All images used are for illustrative purposes only and do not represent the actual size, features, specifications, or fittings. 4. Artlife Developments reserves the right to make revisions/alterations, at its absolute discretion, and without liability.

Private gardens

Modern terraces

with low, green planting and scattered palm trees to frame the views.

Winding walks

between low walls.

Lounge area

surrounded by low vegetation.

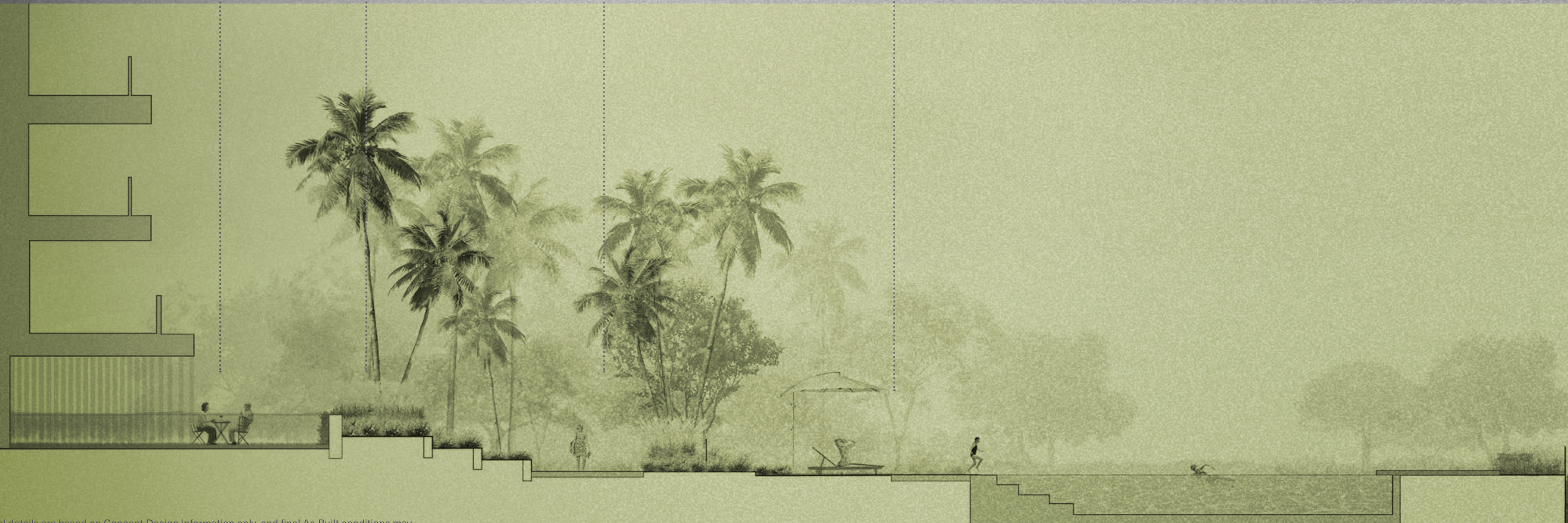

Disclaimer: 1. Drawings are not to scale. 2. The architectural details are based on Concept Design information only, and final As-Built conditions may vary. 3. All images used are for illustrative purposes only and do not represent the actual size, features, specifications, or fittings. 4. Artlife Developments reserves the right to make revisions/alterations, at its absolute discretion, and without liability.

Promenade.

Large evergreen trees provide continuous shade along the promenade, creating year-round greenery.

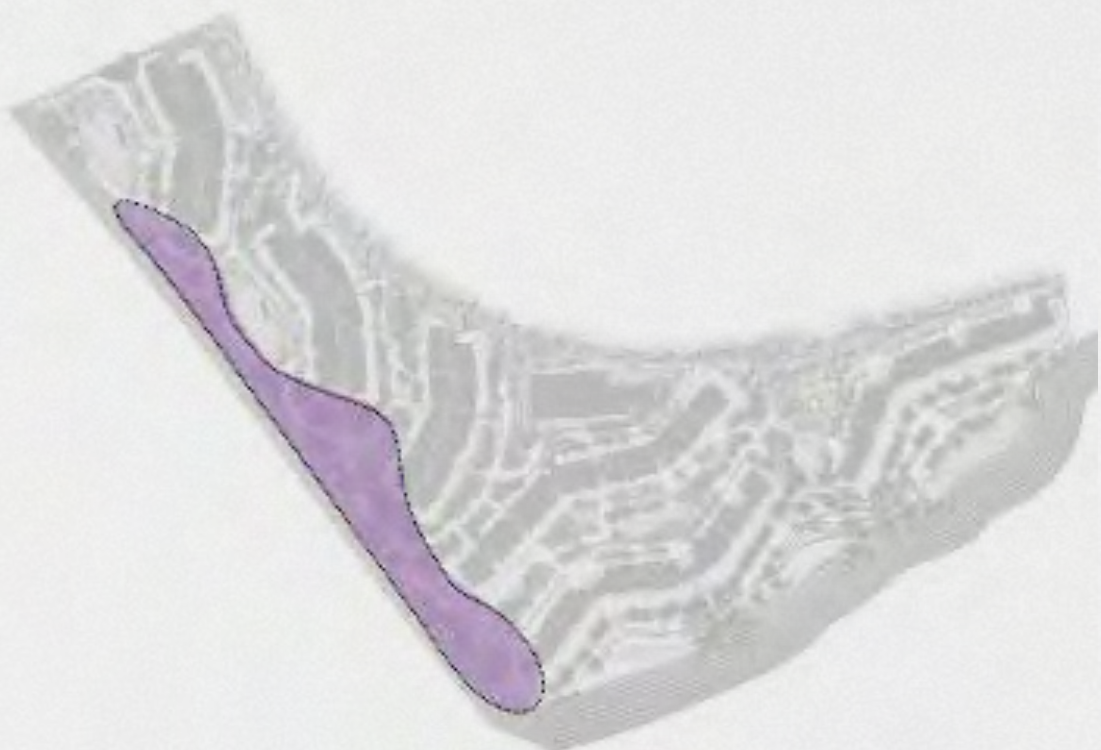

04.

Landscape Design.



Soft Landscape.

Beautiful modern grassy terraces extending the building lines out into the landscape in form of stepped green plinth. Palm trees criss-cross in front of façade added another geometric dimension. Green swathes envelope and form pools and water features being interrupted by the ramblas as a contrast to the modern lines.

Soft Landscape.



Swathes Shade Transparency Resistant Colourful Rockscape Freshness

Planting Strategy.



Green Veil.

Small leaved fast growing tall transparent crowns with delicate flowers to be able to see built form beyond but create homogenous green entrance sequence / facade



Hardscape.

The hard landscape is defined by clean lines and durable materials that complement the building's modern character. Carefully composed paving and structured elements create contrast against the soft, sinuous planting, enhancing both function and visual clarity.

Hardscape.

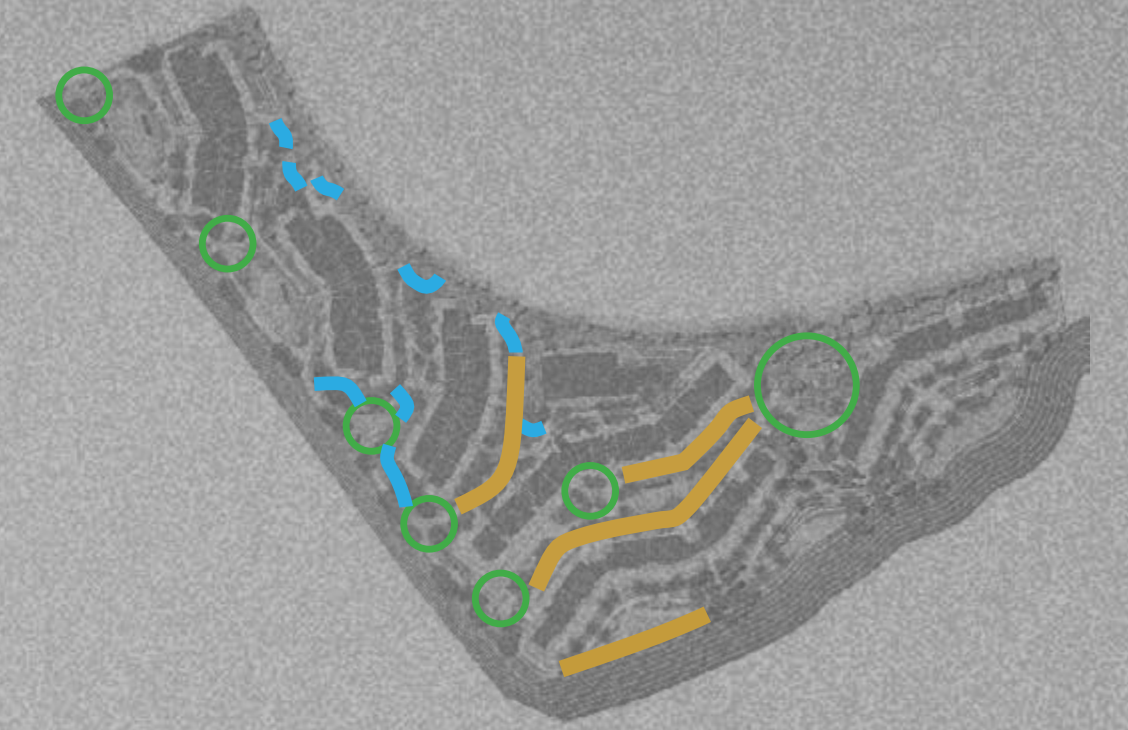

— Rustic stone oversized slabs.

○ Irregular stone slabs inserted into washed concrete path system.

— Washed concrete path with asymmetric stone edge.



Hardscape.

Asymmetric organic and curved washed concrete path.



Stepping stones inset in grass.

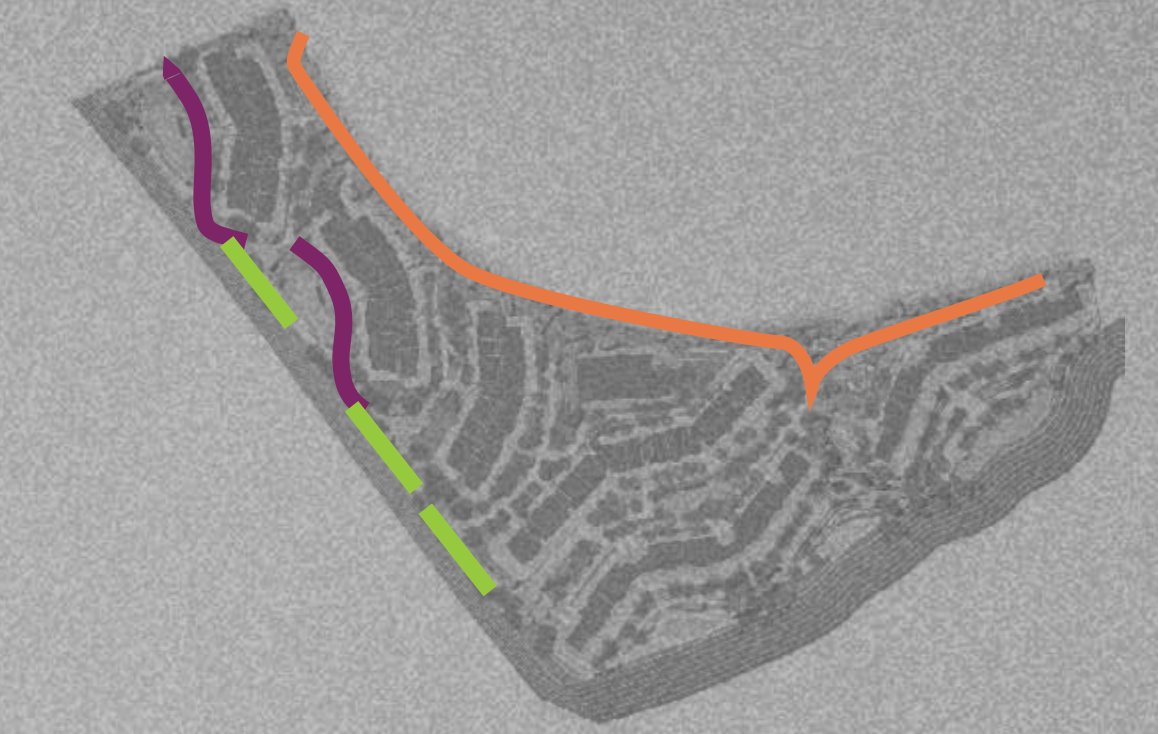

Precast concrete setts, stretcher bond pattern.



Lighting Design.

The lighting design creates an evocative atmosphere through smooth, understated illumination that enhances form and texture. Warm tones and carefully positioned fixtures foster a comfortable, homey ambiance, transforming the landscape into an inviting and intimate experience.

Lighting Design.



Evocative



Smooth



Comfortable



Homey

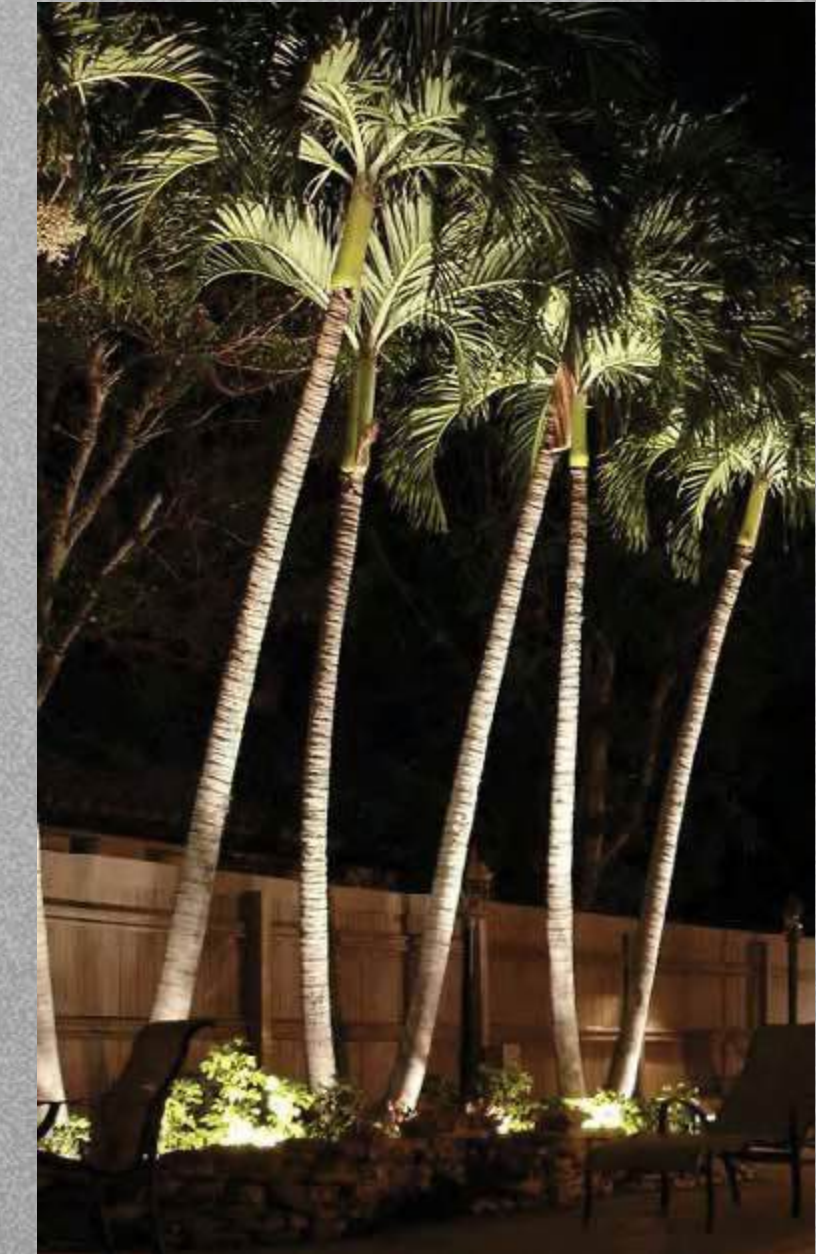

Lighting Strategy.

● LAMP POST (3m HIGHT) Light-
ing to the floor with round lamp



● TALL BOLLARD LIGHT (0,6m HIGHT)
Lighting to the floor with round lamp



● TALL BOLLARD LIGHT (0,35m HIGHT)
Lighting to the floor with round lamp



■ WALL LIGHT Recessed
marker LED



▲ SPOTLIGHT UNDER TREE Micro
round spot



▲ SPOTLIGHT UNDER PALM Micro
round spot "Blade of light"



✦ FOUNTAIN SPOTLIGHT
Underwater projector LED



▲ POOL FLOODLIGHT LED Recessed
submersion light

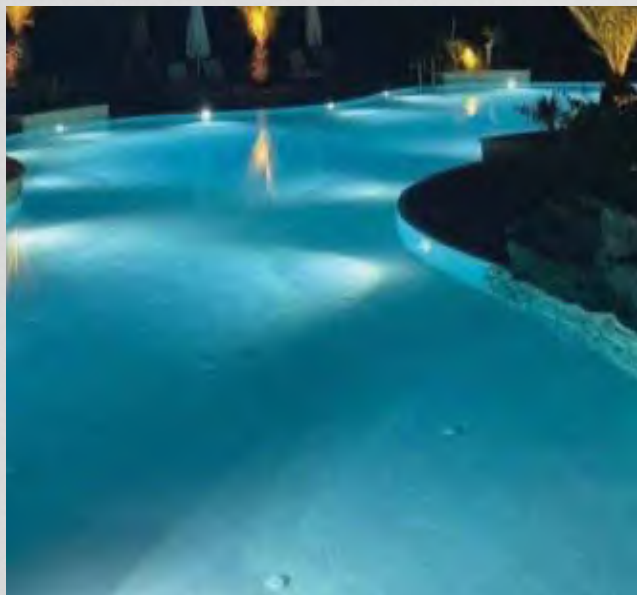

■ STEP LIGHT IN RISER Recessed
marker LED



■ LED INTEGRATED UNDER WALL Linear
LED integrated under wall coping

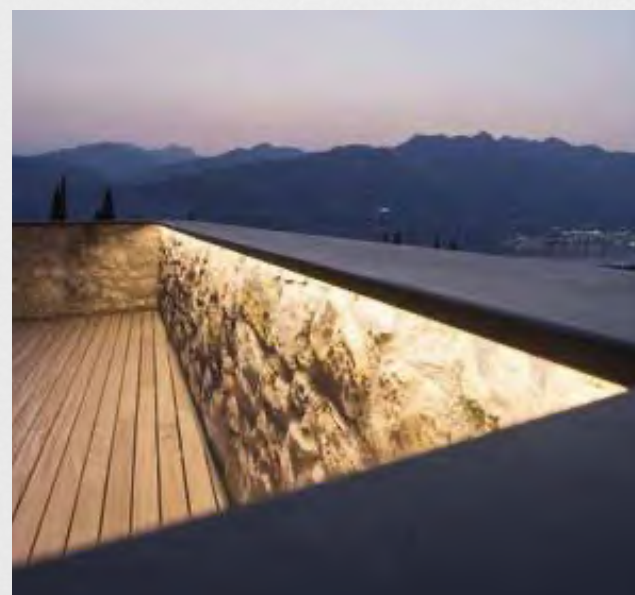

■ LED INTEGRATED UNDER BENCH
Continuous linear comfort recessed



● LAMP POST (3M HIGHT)

✦ FOUNTAIN SPOTLIGHT

● TALL BOLLARD LIGHT (0,6M HIGHT)

▲ POOL FLOODLIGHT LED

● SMALL BOLLARD LIGHT (0,35M HIGHT)

■ STEP LIGHT IN RISER

■ WALL LIGHT

■ LED INTEGRATED IN WALL

▲ SPOTLIGHT UNDER TREE

■ LED INTEGRATED UNDER BENCH

▲ SPOTLIGHT UNDER PALM



Your own private oasis.

Discover a serene retreat with beautifully elevated landscapes designed for maximum privacy. Each residence is enveloped in lush, secluded enclaves, creating an exclusive, peaceful atmosphere.

Enjoy the luxury of your own swimming pool located in front of each building, providing the perfect setting for relaxation.

Thoughtfully planted trees enhance the environment, offering natural cooling and contributing to a tranquil oasis right at your doorstep.

An aerial architectural rendering of a resort-style swimming pool. The pool is large and irregularly shaped, with clear turquoise water. It is surrounded by a light-colored stone or concrete deck. Along the pool's edge, there are several lounge chairs with white cushions. Some lounge chairs are on a green lawn area, while others are on the deck. There are several palm trees scattered around the pool area. In the upper right, there is a wooden deck area with more lounge chairs. A few people are visible: one person is swimming in the pool, and several others are standing or sitting on the deck. The overall atmosphere is relaxed and luxurious.

Resort-style Pool Experience.

Disclaimer: 1. Drawings are not to scale. 2. The architectural details are based on Concept Design information only, and final As-Built conditions may vary. 3. All images used are for illustrative purposes only and do not represent the actual size, features, specifications, or fittings. 4. Artlife Developments reserves the right to make revisions/alterations, at its absolute discretion, and without liability.

Twilight Spectre Series.
@newgiza

Serene Nature-scape Surroundings.



Disclaimer: 1. Drawings are not to scale. 2. The architectural details are based on Concept Design information only, and final As-Built conditions may vary. 3. All images used are for illustrative purposes only and do not represent the actual size, features, specifications, or fittings. 4. Artlife Developments reserves the right to make revisions/alterations, at its absolute discretion, and without liability.

Outdoor Pool Area.



Disclaimer: 1. Drawings are not to scale. 2. The architectural details are based on Concept Design information only, and final As-Built conditions may vary. 3. All images used are for illustrative purposes only and do not represent the actual size, features, specifications, or fittings. 4. Artlife Developments reserves the right to make revisions/alterations, at its absolute discretion, and without liability.



Play Areas.

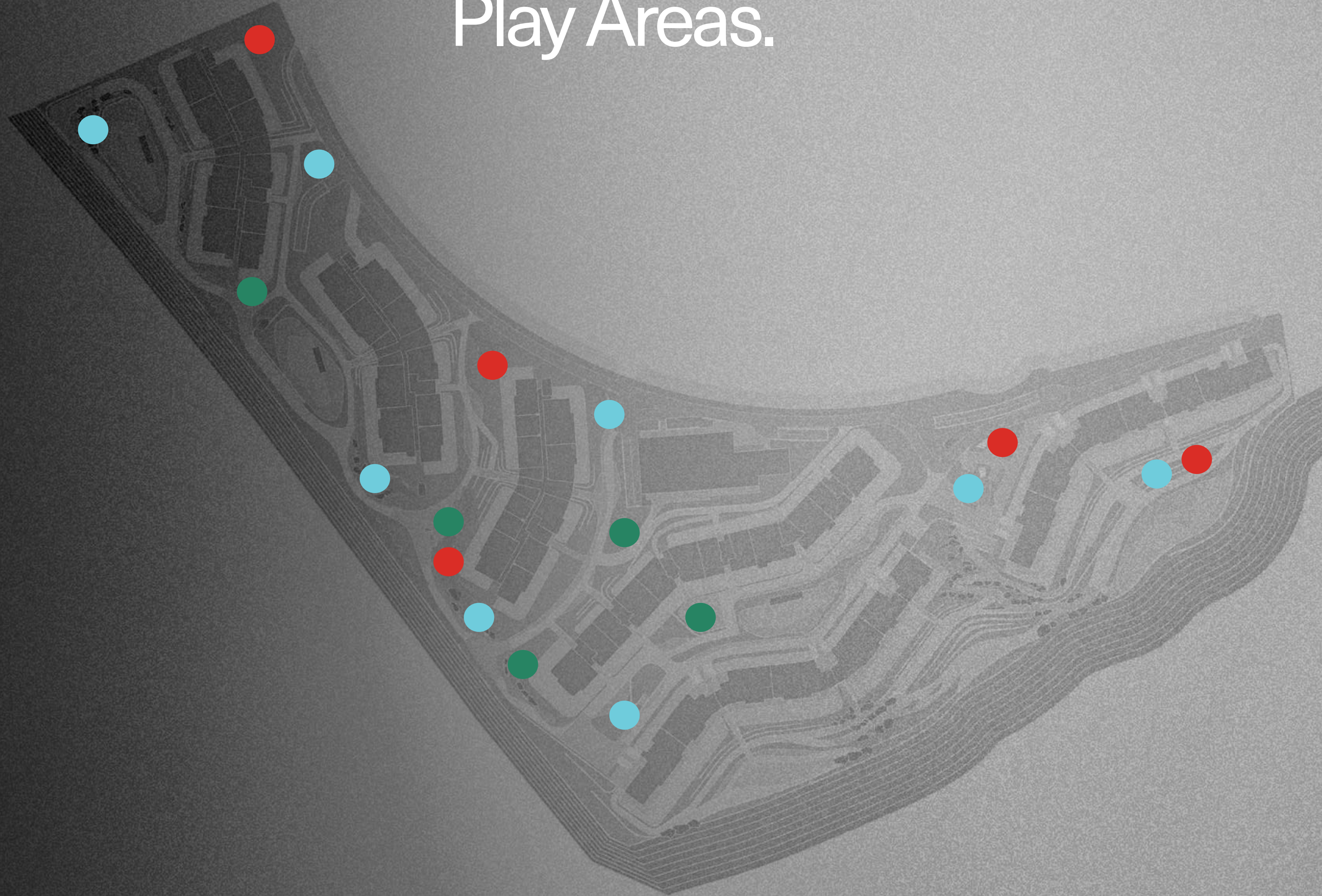

Key.

● Playground Areas

● Exercise Areas

● Teenagers/Adults Meeting Areas

05.

The World of Twilight.

A panoramic escape blending nature & heritage.

Twilight Residences is thoughtfully planned, utilizing smart levelling techniques that transform each home into a panoramic escape, showcasing open skies, ancient history, and emerald fields of meticulously manicured landscapes.



Seamlessly Integrated Design.

Disclaimer: 1. Drawings are not to scale. 2. The architectural details are based on Concept Design information only, and final As-Built conditions may vary. 3. All images used are for illustrative purposes only and do not represent the actual size, features, specifications, or fittings. 4. Artlife Developments reserves the right to make revisions/alterations, at its absolute discretion, and without liability.

Twilight Spectre Series.
@newgiza



Panoramic Landscape Views.

Disclaimer: 1. Drawings are not to scale. 2. The architectural details are based on Concept Design information only, and final As-Built conditions may vary. 3. All images used are for illustrative purposes only and do not represent the actual size, features, specifications, or fittings. 4. Artlife Developments reserves the right to make revisions/alterations, at its absolute discretion, and without liability.

Twilight Spectre Series.
@newgiza



Elevated Architectural Perspective.

Disclaimer: 1. Drawings are not to scale. 2. The architectural details are based on Concept Design information only, and final As-Built conditions may vary. 3. All images used are for illustrative purposes only and do not represent the actual size, features, specifications, or fittings. 4. Artlife Developments reserves the right to make revisions/alterations, at its absolute discretion, and without liability.

Twilight Spectre Series.
@newgiza



Refined Architectural Lines.

Disclaimer: 1-Drawings are not to scale. 2-The architectural details are based on Concept Design information only, and final AS-Built conditions may vary. 3-All images used are for illustrative purposes only and do not represent the actual size, features, specifications, or fittings. 4-ArLife Developments reserves the right to make revisions/alterations, at its absolute discretion, and without liability.

Twilight Spectre Series.
@newgiza



Serene Poolside Views.

Disclaimer: 1. Drawings are not to scale. 2. The architectural details are based on Concept Design information only, and final As-Built conditions may vary. 3. All images used are for illustrative purposes only and do not represent the actual size, features, specifications, or fittings. 4. Artlife Developments reserves the right to make revisions/alterations, at its absolute discretion, and without liability.



Contemporary Outdoor Living.

Disclaimer: 1. Drawings are not to scale. 2. The architectural details are based on Concept Design information only, and final As-Built conditions may vary. 3. All images used are for illustrative purposes only and do not represent the actual size, features, specifications, or fittings. 4. Artlife Developments reserves the right to make revisions/alterations, at its absolute discretion, and without liability.

Twilight Spectre Series.
@newgiza



Refined Lines and Sophisticated Facades.

Disclaimer: 1. Drawings are not to scale. 2. The architectural details are based on Concept Design information only, and final As-Built conditions may vary. 3. All images used are for illustrative purposes only and do not represent the actual size, features, specifications, or fittings. 4. Artlife Developments reserves the right to make revisions/alterations, at its absolute discretion, and without liability.

Twilight Spectre Series.
@newgiza



B6
CORE-02

Exterior Access.

Disclaimer: 1. Drawings are not to scale. 2. The architectural details are based on Concept Design information only, and final As-Built conditions may vary. 3. All images used are for illustrative purposes only and do not represent the actual size, features, specifications, or fittings. 4. Artlife Developments reserves the right to make revisions/alterations, at its absolute discretion, and without liability.

Twilight Spectre Series.
@newgiza



Elegant Poolside Living.

Disclaimer: 1. Drawings are not to scale. 2. The architectural details are based on Concept Design information only, and final As-Built conditions may vary. 3. All images used are for illustrative purposes only and do not represent the actual size, features, specifications, or fittings. 4. Artlife Developments reserves the right to make revisions/alterations, at its absolute discretion, and without liability.

Twilight Spectre Series
@newgiza



Refined Architectural Expression.

Disclaimer: 1. Drawings are not to scale. 2. The architectural details are based on Concept Design information only, and final As-Built conditions may vary. 3. All images used are for illustrative purposes only and do not represent the actual size, features, specifications, or fittings. 4. Artlife Developments reserves the right to make revisions/alterations, at its absolute discretion, and without liability.

Twilight Spectre Series.
@newgiza



Luxurious Living Spaces.

Disclaimer: 1. Drawings are not to scale. 2. The architectural details are based on Concept Design information only, and final As-Built conditions may vary. 3. All images used are for illustrative purposes only and do not represent the actual size, features, specifications, or fittings. 4. Artlife Developments reserves the right to make revisions/alterations, at its absolute discretion, and without liability.

Twilight Spectre Series.
@newgiza



Harmoniously Designed Interiors.

Disclaimer: 1. Drawings are not to scale. 2. The architectural details are based on Concept Design information only, and final As-Built conditions may vary. 3. All images used are for illustrative purposes only and do not represent the actual size, features, specifications, or fittings. 4. Artlife Developments reserves the right to make revisions/alterations, at its absolute discretion, and without liability.

Twilight Spectre Series.
@newgiza



Expansive Sunlit Interiors.

Disclaimer: 1. Drawings are not to scale. 2. The architectural details are based on Concept Design information only, and final As-Built conditions may vary. 3. All images used are for illustrative purposes only and do not represent the actual size, features, specifications, or fittings. 4. Artlife Developments reserves the right to make revisions/alterations, at its absolute discretion, and without liability.

Twilight Spectre Series.
@newgiza

Luxurious Lobby Area.



Disclaimer: 1. Drawings are not to scale. 2. The architectural details are based on Concept Design information only, and final As-Built conditions may vary. 3. All images used are for illustrative purposes only and do not represent the actual size, features, specifications, or fittings. 4. Artlife Developments reserves the right to make revisions/alterations, at its absolute discretion, and without liability.

Exquisitely Designed
Lobby with Immaculate
Detailing.



Harmoniously Designed Lobby.



Disclaimer: 1. Drawings are not to scale. 2. The architectural details are based on Concept Design information only, and final As-Built conditions may vary. 3. All images used are for illustrative purposes only and do not represent the actual size, features, specifications, or fittings. 4. Artlife Developments reserves the right to make revisions/alterations, at its absolute discretion, and without liability.

Seamless Indoor/Outdoor
Integration.

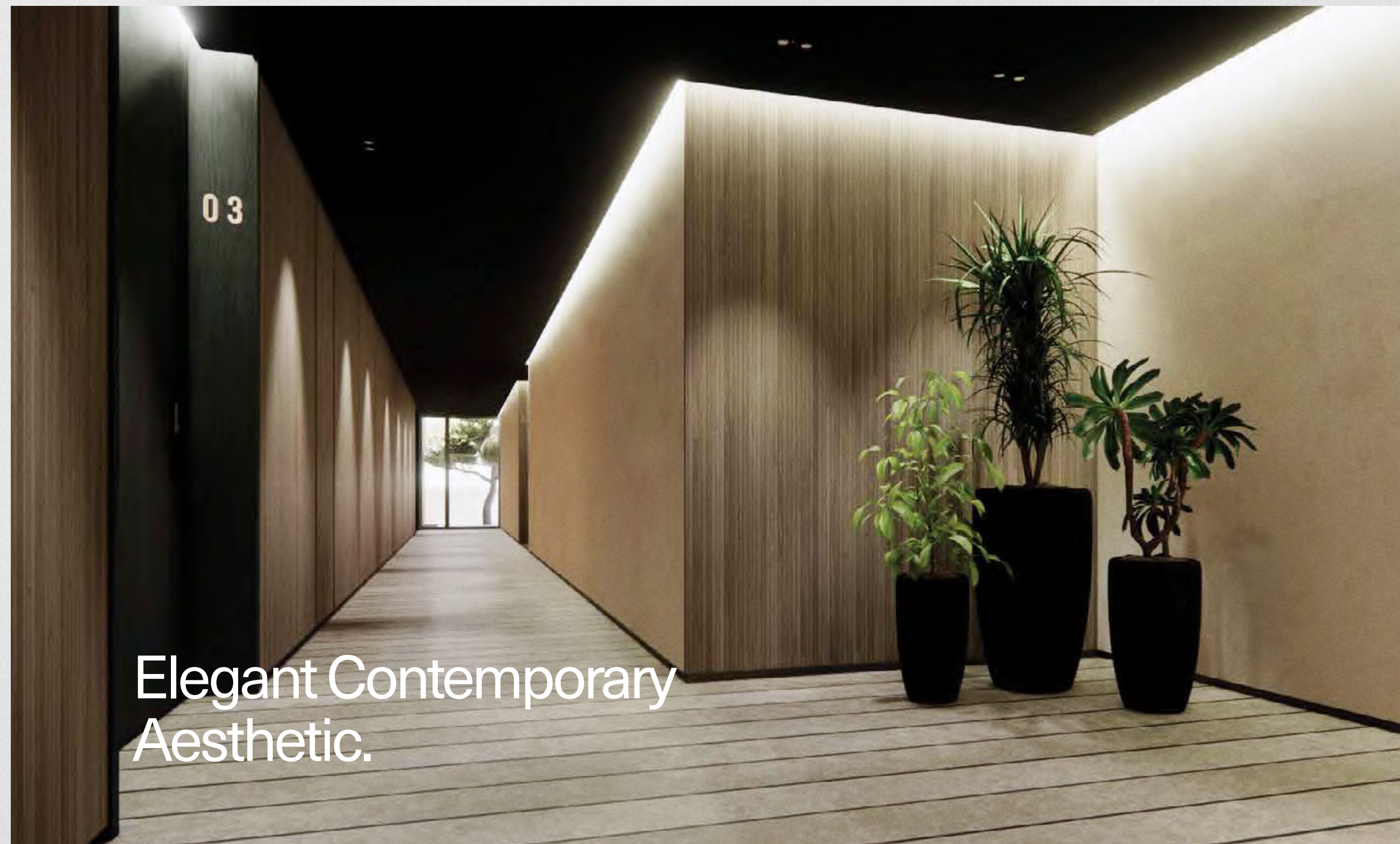

Elegant Contemporary
Aesthetic.

Spacious Underground Parking.



Disclaimer: 1. Drawings are not to scale. 2. The architectural details are based on Concept Design information only, and final As-Built conditions may vary. 3. All images used are for illustrative purposes only and do not represent the actual size, features, specifications, or fittings. 4. Artlife Developments reserves the right to make revisions/alterations, at its absolute discretion, and without liability.

Twilight Spectre Series.
@newgiza

An exclusive clubhouse.

The Twilight Clubhouse is exclusively designed for the residents of Twilight. This private space features a sophisticated business lounge, diverse dining options, and a state-of-the-art gym. The Twilight Clubhouse is dedicated to enhancing the residents' experience and convenience.



Prestigious Clubhouse.

Disclaimer: 1. Drawings are not to scale. 2. The architectural details are based on Concept Design information only, and final As-Built conditions may vary. 3. All images used are for illustrative purposes only and do not represent the actual size, features, specifications, or fittings. 4. Artlife Developments reserves the right to make revisions/alterations, at its absolute discretion, and without liability.

Twilight Spectre Series.
@newgiza



Elegant Social Space.

Disclaimer: 1. Drawings are not to scale. 2. The architectural details are based on Concept Design information only, and final As-Built conditions may vary. 3. All images used are for illustrative purposes only and do not represent the actual size, features, specifications, or fittings. 4. Artlife Developments reserves the right to make revisions/alterations, at its absolute discretion, and without liability.

Twilight Spectre Series.
@newgiza



Refined Leisure Venue.

Disclaimer: 1. Drawings are not to scale. 2. The architectural details are based on Concept Design information only, and final As-Built conditions may vary. 3. All images used are for illustrative purposes only and do not represent the actual size, features, specifications, or fittings. 4. Artlife Developments reserves the right to make revisions/alterations, at its absolute discretion, and without liability.

Twilight Spectre Series.
@newgiza

Living the Future. Facing History.

Disclaimer: 1. Drawings are not to scale. 2. The architectural details are based on Concept Design information only, and final As-Built conditions may vary. 3. All images used are for illustrative purposes only and do not represent the actual size, features, specifications, or fittings. 4. Artlife Developments reserves the right to make revisions/alterations, at its absolute discretion, and without liability.

Twilight Spectre Series.
@newgiza

06.

Experiential Developments.



Artlife Developments is a pioneering force in the real estate industry, proudly presenting an innovative approach to upscale mixed-use developments, with 20 years of industry experience.

Our mission is to create vibrant, integrated communities that blend residential, commercial, and hospitality spaces, fostering a dynamic environment for living and working.

With a focus on exceptional design and quality, Artlife Developments is setting new standards in urban development and enhancing the way people experience their surroundings. Artlife Developments stands out with our specialization in experiential development.

Twilight Spectre Series.

@newgiza